

GÓC LÊN ĐỨNG - RISING ELBOW (VEU1005-TASI)

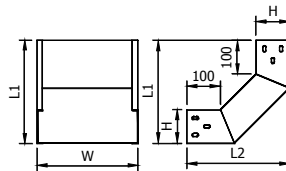
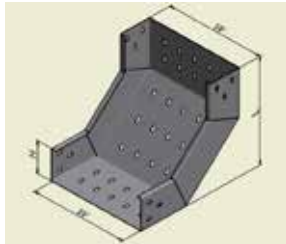

Width W (mm)	Height H (mm)	Size L ₁ (mm)	Size L ₂ (mm)	Product Code	Types		Thickness T (mm)			Finished			COVER		
					Closed Type	Pole Type	1.2	1.5	2.0	Coating	Pre-Galva	Hot Dip Galva	With Cover	Not Cover	
100	50	256	256	VEU1005	T	P	Not Sure Technical Data	A	B	C	S	Z	M	I	O
	100	306	306	VEU1010											
200	50	256	256	VEU2005											
	100	306	306	VEU2010											
	150	356	356	VEU2010											
300	50	256	256	VEU3005											
	100	306	306	VEU3010											
	150	356	356	VEU3015											
400	100	306	306	VEU4010											
	150	356	356	VEU4015											
500	100	306	306	VEU5010											
	150	356	356	VEU5015											
600	100	306	306	VEU6010											
	150	356	356	VEU6015											
700	100	306	306	VEU7010											
	150	356	356	VEU7015											
800	100	306	306	VEU8010											
	150	356	356	VEU8015											
900	100	306	306	VEU9010											
	150	356	356	VEU9015											

Chú ý: Mã M (mạ kẽm nhúng nóng) chỉ áp dụng cùng mã C (tôn dày 2.0mm)

GÓC XUỐNG ĐỨNG - LOW ELBOW (VED1005-TASI)

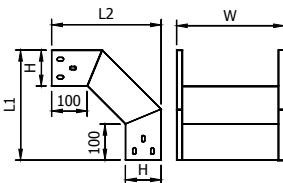
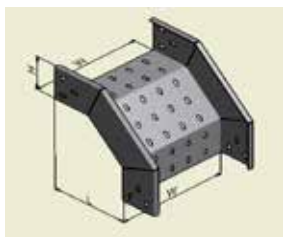

Width W (mm)	Height H (mm)	Size L ₁ (mm)	Size L ₂ (mm)	Product Code	Types		Thickness T (mm)			Finished			COVER		
					Closed Type	Pole Type	1.2	1.5	2.0	Coating	Pre-Galva	Hot Dip Galva	With Cover	Not Cover	
100	50	256	256	VED1005	T	P	Not Sure Technical Data	A	B	C	S	Z	M	I	O
	100	306	306	VED1010											
200	50	256	256	VED2005											
	100	306	306	VED2010											
	150	356	356	VED2010											
300	50	256	256	VED3005											
	100	306	306	VED3010											
	150	356	356	VED3015											
400	100	306	306	VED4010											
	150	356	356	VED4015											
500	100	306	306	VED5010											
	150	356	356	VED5015											
600	100	306	306	VED6010											
	150	356	356	VED6015											
700	100	306	306	VED7010											
	150	356	356	VED7015											
800	100	306	306	VED8010											
	150	356	356	VED8015											
900	100	306	306	VED9010											
	150	356	356	VED9015											

Chú ý: Mã M (mạ kẽm nhúng nóng) chỉ áp dụng cùng mã C (tôn dày 2.0mm)